

PARTS LIST

ITEM	PART #	DESCRIPTION	NOTES
1	K2025/4025	Single Face w/ 6in Radius Corners	Assembly
2	K2086/95/4255	Tension Frame II & Bleed Cover w/ 6in Radius Corners & Covers	Assembly
10	5170	Hinge Screw	Drill 3/8" pilot hole
11	5180	Closure Screw	Drill 5/16" pilot hole

NOTE: PRE-CUT KITS ARE NOT PRE-DRILLED.

(Holes shown in this drawing are for reference only. Drilling of pilot holes are to be done by fabricator.)

***NOTE:** Drill a 3/8" oversized hole for the head of the hinge screw to slip through.

***NOTE:** IT IS RECOMMENDED THAT THE FRAME BE ASSEMBLED ON THE BODY, THEN RATCHET STRAPPED TO CHECK FOR SQUARE, BEFORE THE FRAME IS WELDED OR MECHANICALLY FASTENED.

Ship To:
Sales Order #

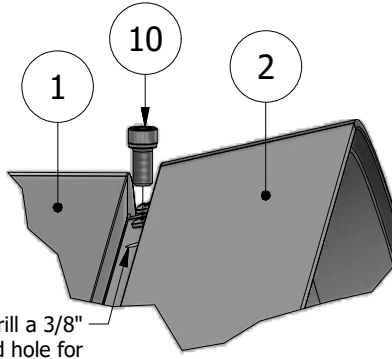
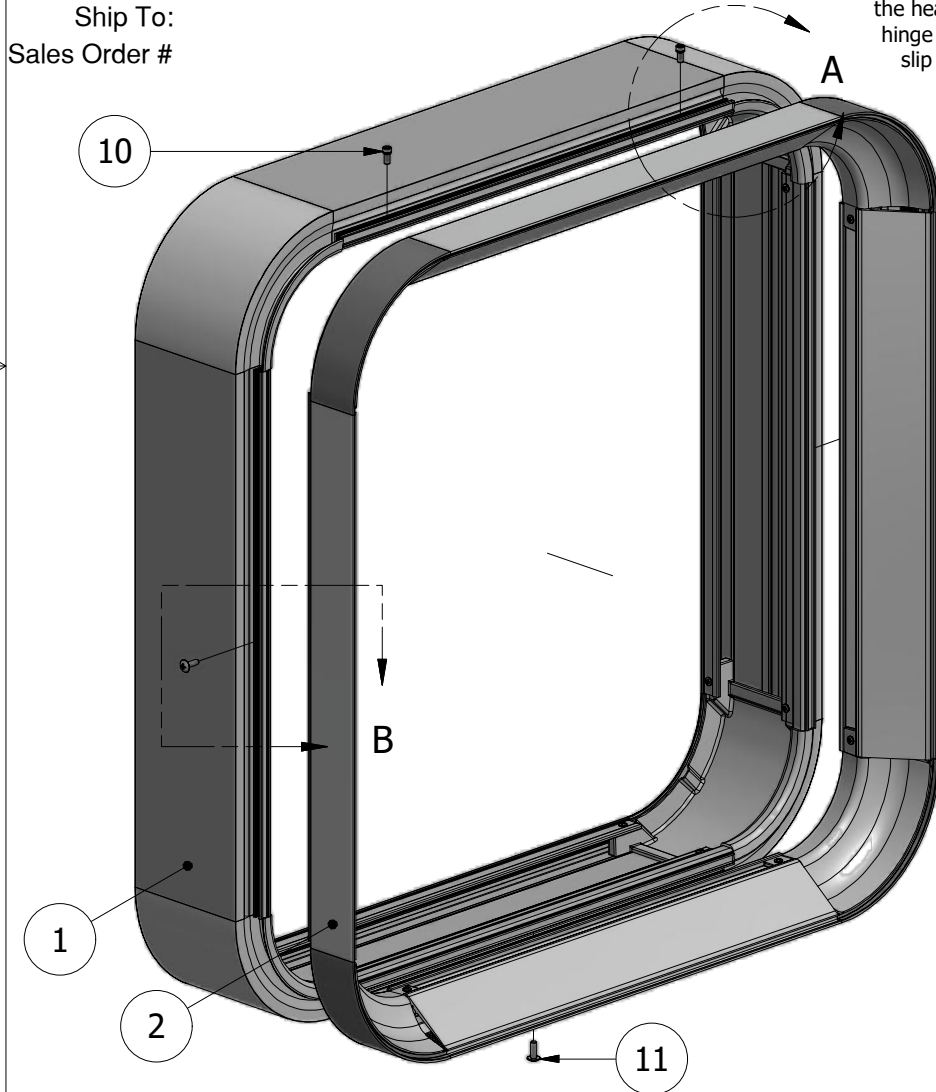

DETAIL A
HINGED

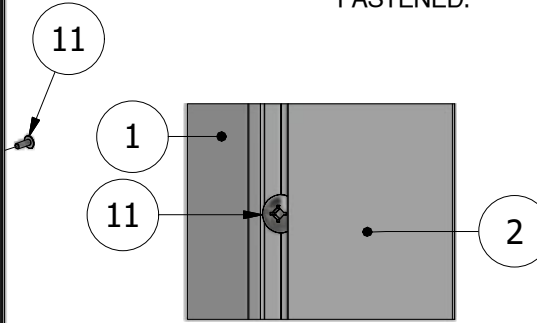
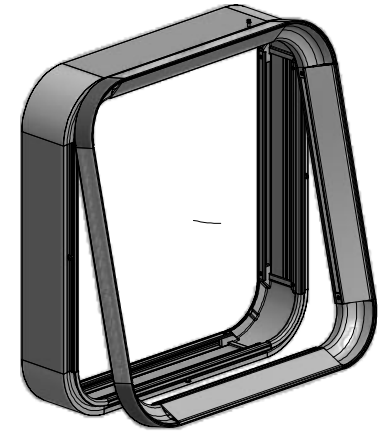

DETAIL B
FRAME CLOSED

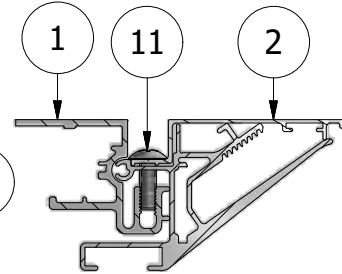

DETAIL B
CROSS-SECTION

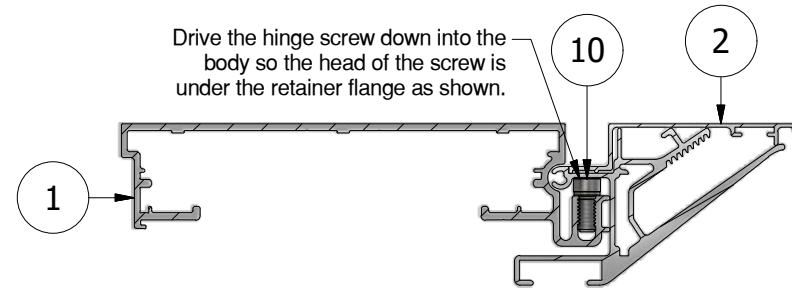

TOP CROSS-SECTION

Drive the hinge screw down into the body so the head of the screw is under the retainer flange as shown.

THIS DRAWING WAS CREATED AT NO CHARGE TO ASSIST YOU IN VISUALIZING OUR PROPOSAL. THE DRAWING HEREIN IS THE PROPERTY OF SIGNCOMP. PERMISSION TO COPY OR REVISE THIS DRAWING OR TO USE THIS DRAWING FOR PRODUCTION IS STRICTLY PROHIBITED AND CAN ONLY BE COPIED, REVISED OR USED FOR PRODUCTION WITH THE EXPRESSED WRITTEN PERMISSION OF SIGNCOMP.

Project Name: **Single Face Body w/Tension Frm II & Bleed Cvr-6" Rad. Corners** Sheet: **1 of 1** Size: **A**

Sign Company: **KSF/86/95/4588** Revision: Drawing By: **SBreihof**

Date: **5/15/2019**



PARTS LIST			
ITEM	PART#	DESCRIPTION	NOTES
1	2025	Single Face Body	Top & Bottom
2	2025	Single Face Body	Sides
3	4025	Single Face Body 6in Radius Corner	
65	5218	Radius Corner Screw	Drill 5/32" pilot hole

Ship To:
Sales Order#

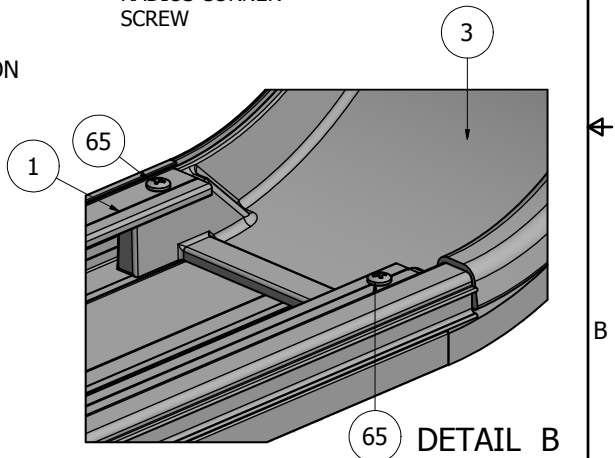
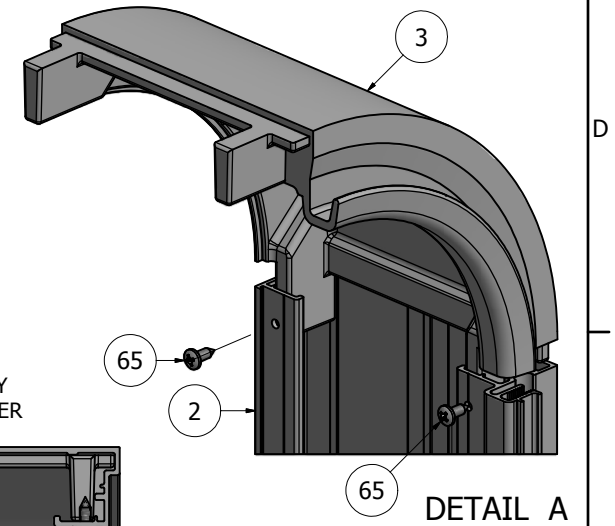
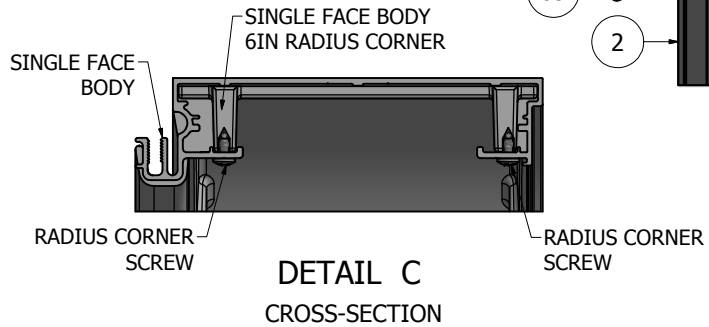
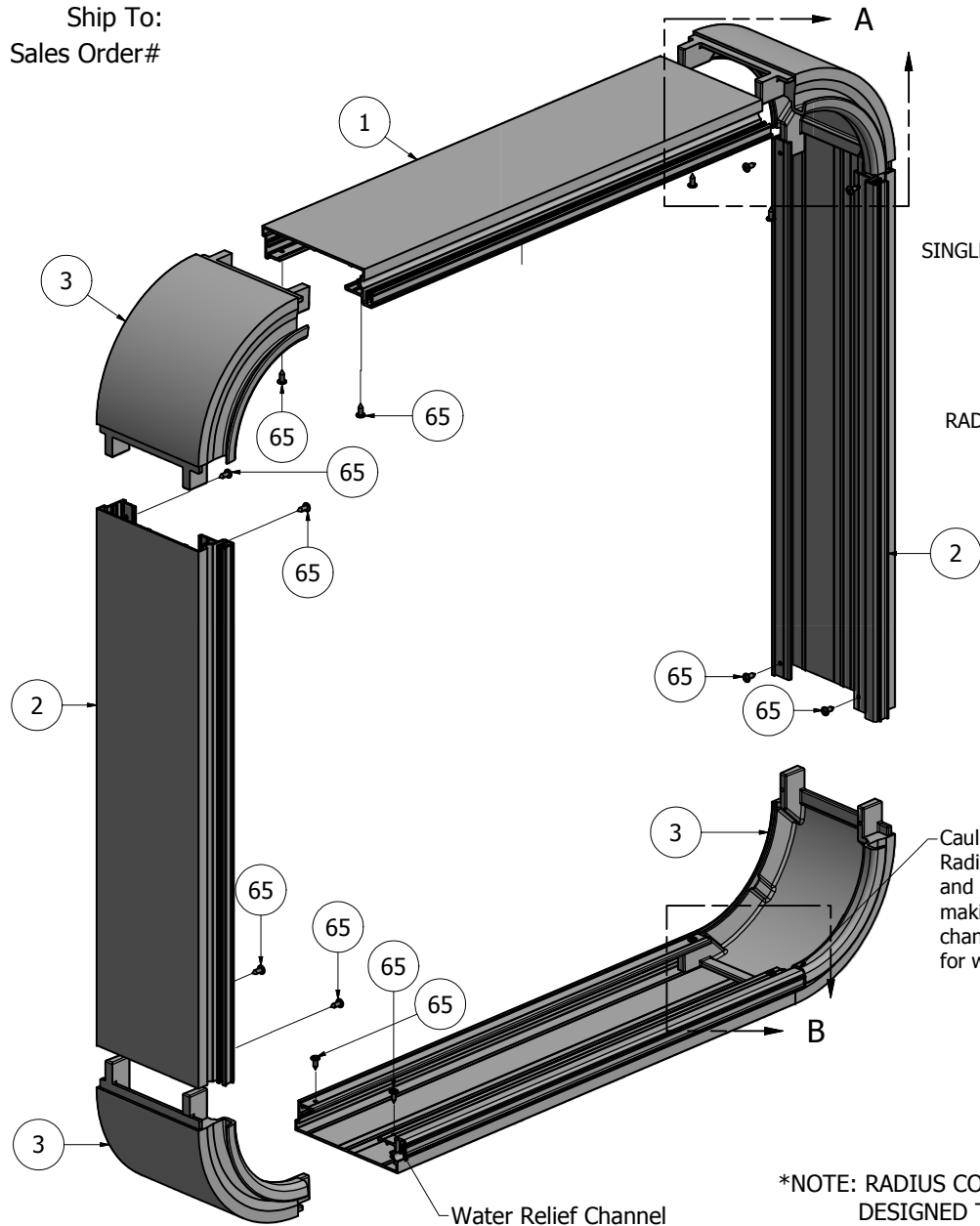

Caulk the joints where the Radius Diecast Corners and the Extrusion meet, yet making sure the water relief channel is not blocked, allowing for water to flow.

NOTE: PRE-CUT KITS ARE NOT PRE-DRILLED.
(Holes shown in this drawing are for reference only. Drilling of pilot holes are to be done by fabricator.)

*NOTE: RADIUS CORNERS ARE DESIGNED TO BE WELDED, HOWEVER CAN ALSO BE MECHANICALLY ASSEMBLED.

THIS DRAWING WAS CREATED AT NO CHARGE TO ASSIST YOU IN VISUALIZING OUR PROPOSAL. THE DRAWING HEREIN IS THE PROPERTY OF SIGNCOMP. PERMISSION TO COPY OR REVISE THIS DRAWING OR TO USE THIS DRAWING FOR PRODUCTION IS STRICTLY PROHIBITED AND CAN ONLY BE COPIED, REVISED OR USED FOR PRODUCTION WITH THE EXPRESSED WRITTEN PERMISSION OF SIGNCOMP.			
DRAWN	SBreihof	9/4/2012	SignComp
Centroid X:	0.000 in		
Centroid Y:	0.000 in		TITLE
Principal Moments Ix:	0.000 in ⁴		Single Face Body w/ 6in Radius Corners - Assembly
Principal Moments Iy:	0.000 in ⁴		DWG NO
Section Modulus Ix:	0.000 in ³		KSF-4025
Section Modulus Iy:	0.000 in ³		REV
			SHEET 1 OF 1

PARTS LIST			
ITEM	PART #	DESCRIPTION	NOTES
1	2086	Tension Frame II	Top & Bottom
2	2086	Tension Frame II	Sides
3	4255	6in Tension Frame II Radius Corner	All 4 Corners
65	5218	Radius Corner Screw	Drill 5/32" pilot hole

NOTE: PRE-CUT KITS ARE NOT PRE-DRILLED.

(Holes shown in this drawing are for reference only.
Drilling of pilot holes are to be done by fabricator.)

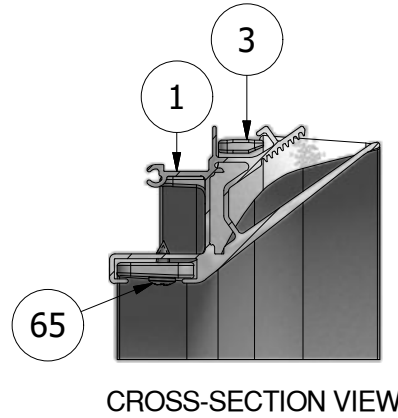
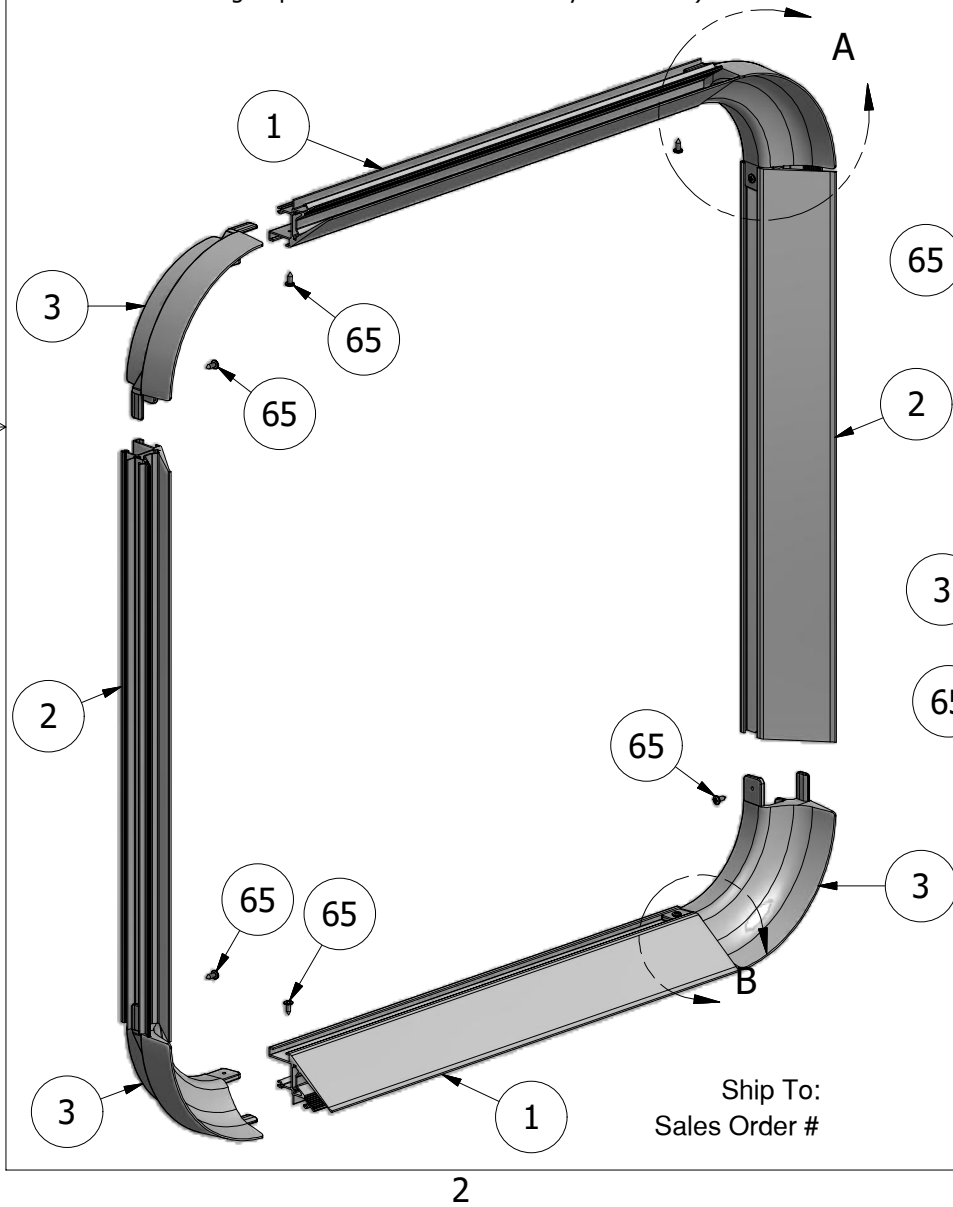

***NOTE: GAPS ARE REQUIRED FOR PROPER ASSEMBLY.**

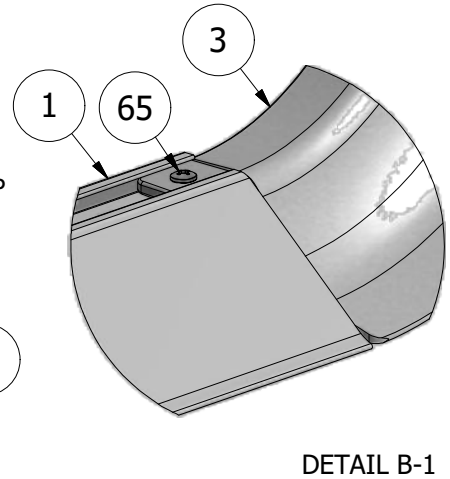
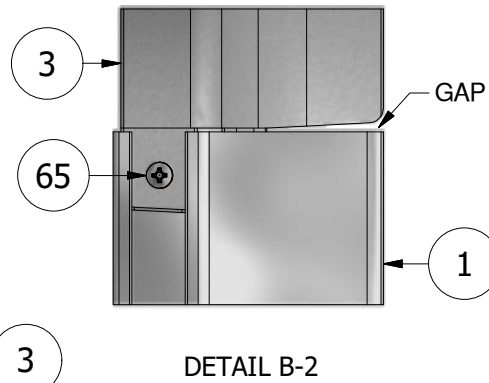

***NOTE: IT IS RECOMMENDED THAT THE FRAME BE ASSEMBLED ON THE BODY, THEN RATCHET STRAPPED TO CHECK FOR SQUARE, BEFORE THE FRAME IS WELDED OR MECHANICALLY FASTENED.**

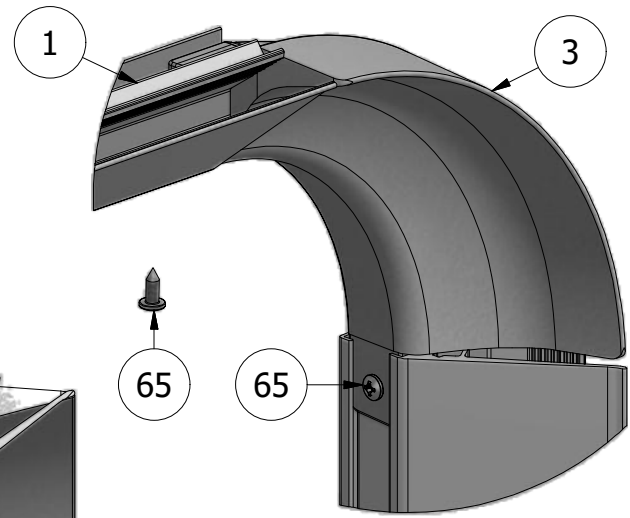

DETAIL A

THIS DRAWING WAS CREATED AT NO CHARGE TO ASSIST YOU IN VISUALIZING OUR PROPOSAL. THE DRAWING HEREIN IS THE PROPERTY OF SIGNCOMP. PERMISSION TO COPY OR REVISE THIS DRAWING OR TO USE THIS DRAWING FOR PRODUCTION IS STRICTLY PROHIBITED AND CAN ONLY BE COPIED, REVISED OR USED FOR PRODUCTION WITH THE EXPRESSED WRITTEN PERMISSION OF SIGNCOMP.

Project Name: Tension Frame II with 6" Rad. Corners - Assembly

Sign Company: K2086-4255

Part #:

Revision:

Date: 5/14/2019

Sheet: 1 of 1

Size:

A

Drawing By: SBreihof

SignComp

B

A

B

A

2

2

1

1

PARTS LIST

ITEM	PART #	DESCRIPTION	NOTES
1	K2086/4255	Tension Frame II w/ 6in Radius Corners	Assembly
2	2095	Bleed Tension Frame Cover	Top & Bottom
3	2095	Bleed Tension Frame Cover	Sides
4	4265P	6in Bleed Tension Frame Radius Cover	
12	5195	Cover Screw	Pre-drill 3/32" hole
15	5195	Radius Corner Cover Screw	Pre-drill 3/32" hole

Ship To:
Sales Order #

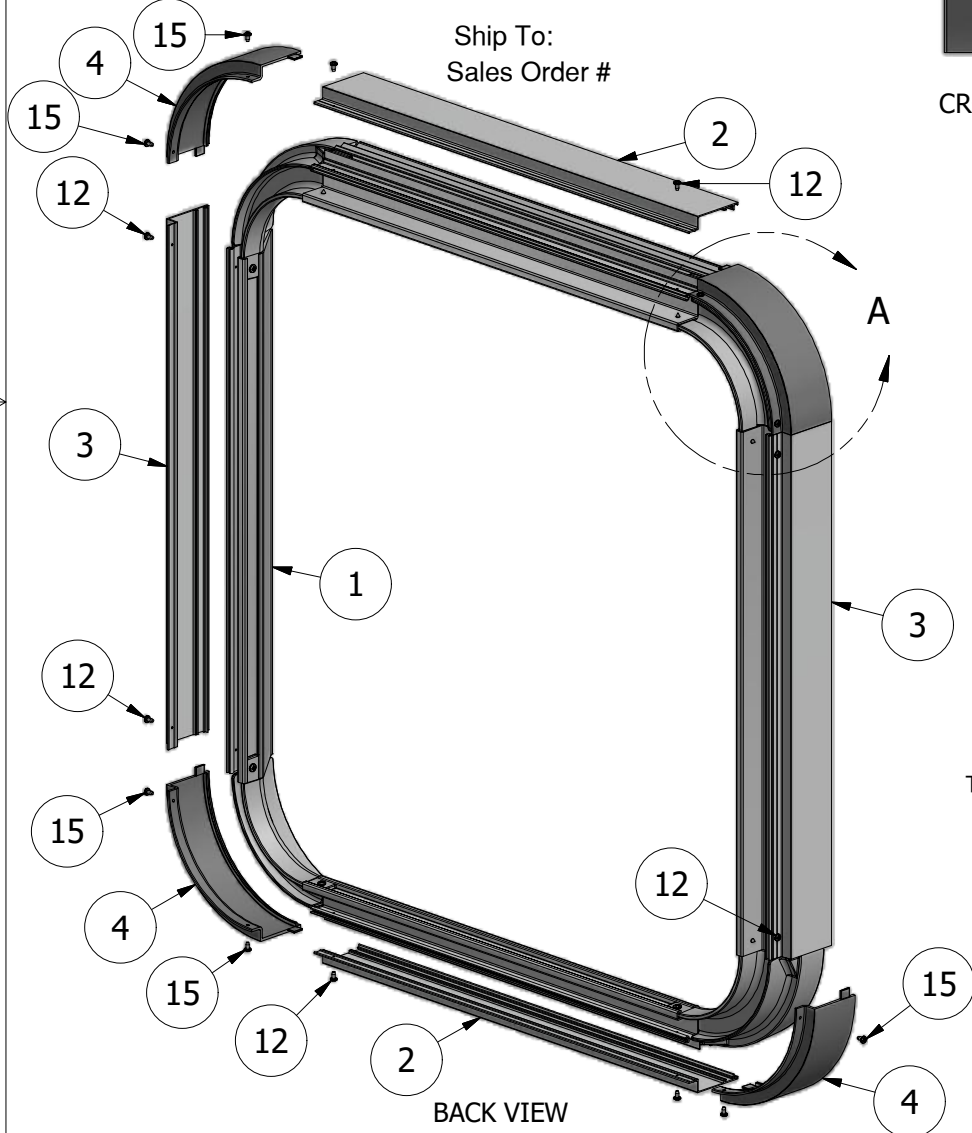

BACK VIEW

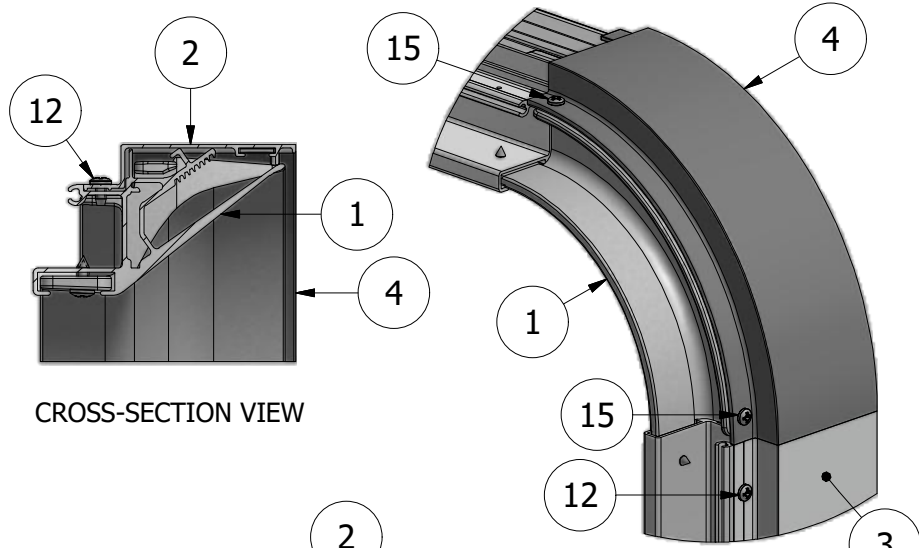

CROSS-SECTION VIEW

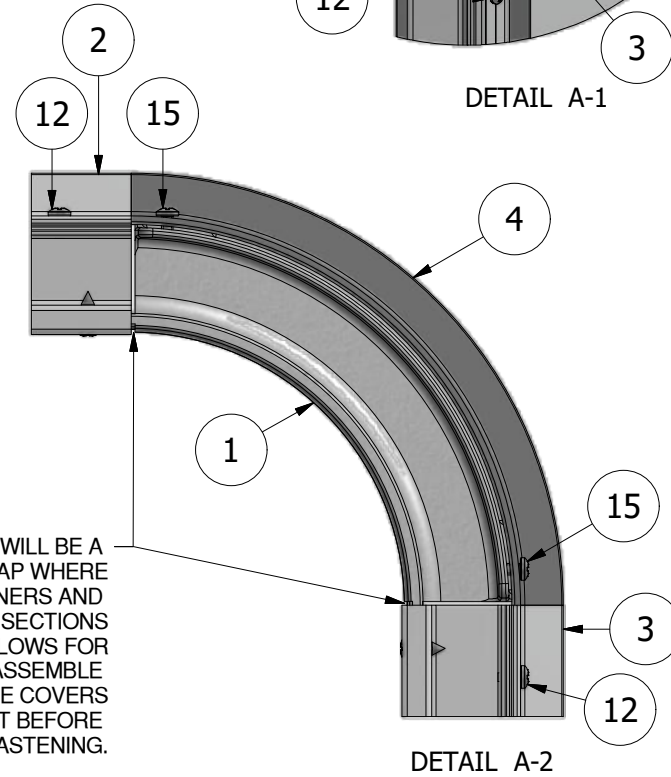

DETAIL A-2

***NOTE:** THERE WILL BE A CONSISTANT GAP WHERE THE RADIUS CORNERS AND TENSION FRAME SECTIONS MEET. THIS ALLOWS FOR THE FRAME TO ASSEMBLE SQUARE AND THE COVERS TO FIT TIGHT BEFORE FASTENING.

NOTE: PRE-CUT KITS ARE NOT PRE-DRILLED.
(Holes shown in this drawing are for reference only. Drilling of pilot holes are to be done by fabricator.)

THIS DRAWING WAS CREATED AT NO CHARGE TO ASSIST YOU IN VISUALIZING OUR PROPOSAL. THE DRAWING HEREIN IS THE PROPERTY OF SIGNCOMP. PERMISSION TO COPY OR REVISE THIS DRAWING OR TO USE THIS DRAWING FOR PRODUCTION IS STRICTLY PROHIBITED AND CAN ONLY BE COPIED, REVISED OR USED FOR PRODUCTION WITH THE EXPRESSED WRITTEN PERMISSION OF SIGNCOMP.

SignComp	Project Name: Tension Frame II and Bleed Cover - 6" Rad. Covers - Assembly
	Part #: K2086-95-4265P
Size: A	Drawing By: SBreihof
Sheet: 1 of 1	Date: 5/14/2019
Revision:	Revision:

PARTS LIST		
ITEM	PART #	DESCRIPTION
1	2025	Single Face Body
2	5322	Single Face Body Corner Angle
3		.060 Alum. Back
4		Alum. Back Support
5		Alum. Gusset
6	5112	Raceway Cover - Blank
7		Lamp & Socket
8	2086	Tension Frame II
9	5210	Corner Key
10	5305	Frame Corner Angle
11	2095	Bleed Tension Frame Cover
12	5350	Frame Brace
13	2175	Frame Support Tube

NOTE: PRE-CUT KITS ARE NOT PRE-DRILLED.
 (Holes shown in this drawing are for reference only.
 Drilling of pilot holes are to be done by fabricator.)

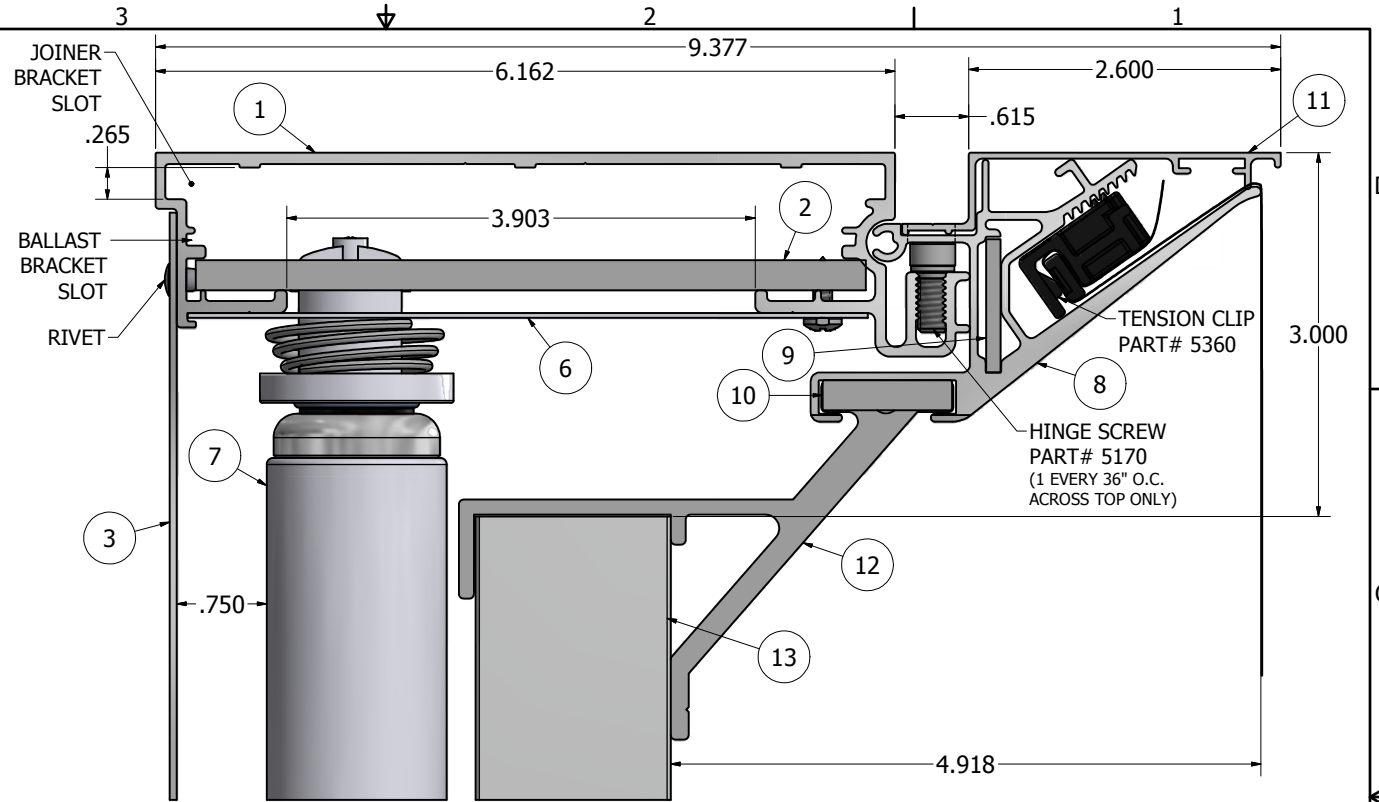

SECTION VIEW - ELECTRICAL

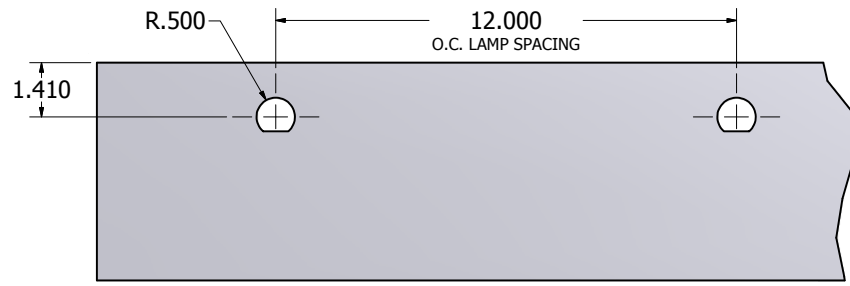

RACEWAY D-PUNCH DETAIL

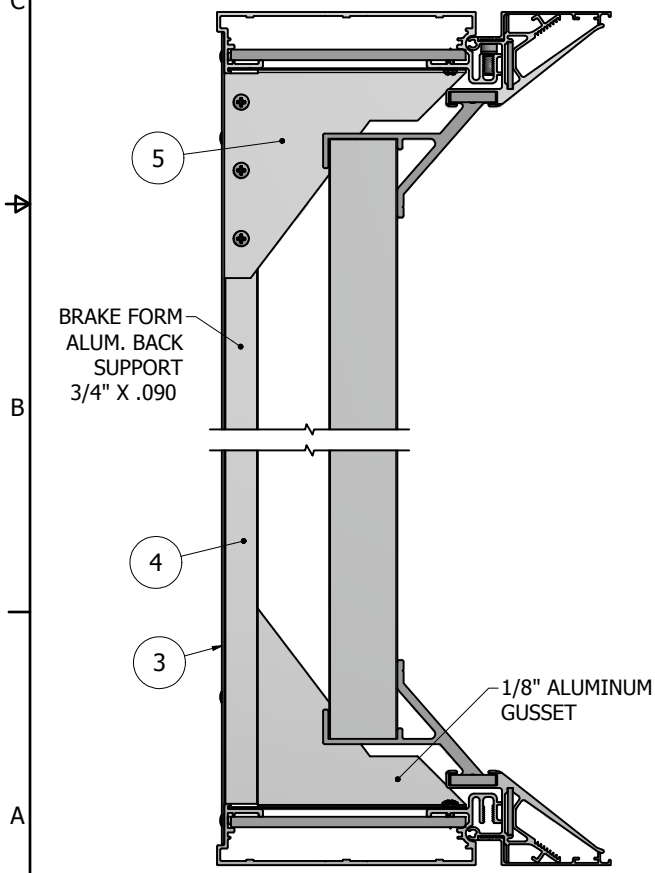

SECTION VIEW - STRUCTURAL

- NOTES
1. ADD 1" TO SIZE OF CABINET (VERTICAL OR HORIZONTAL) WHEN THE SIZE OF THE CABINET IS THE SAME SIZE AS THE NOMINAL LAMP LENGTH.
 2. SIGNCOMP DOES NOT SUPPLY THE BALLAST(S), LAMPS, LAMP SOCKETS OR THE ALUMINUM BACK.
 3. SIGNCOMP DOES NOT SUPPLY THE MATERIAL FOR GUSSETS, 1/4" JOINER BRACKET OR ALUMINUM BACK.

THIS DRAWING WAS CREATED AT NO CHARGE TO ASSIST YOU IN VISUALIZING OUR PROPOSAL. THE DRAWING HEREIN IS THE PROPERTY OF SIGNCOMP. PERMISSION TO COPY OR REVISE THIS DRAWING OR TO USE THIS DRAWING FOR PRODUCTION IS STRICTLY PROHIBITED AND CAN ONLY BE COPIED, REVISED OR USED FOR PRODUCTION WITH THE EXPRESSED WRITTEN PERMISSION OF SIGNCOMP.			
DRAWING BY:	SBreihof	6/10/2014	SignComp
Centroid X:	0.000 in		
Centroid Y:	0.000 in		TITLE
Principal Moments Ix:	0.000 in ⁴		Single Face Body with Tension Frame II and Bleed Cover - Cross Sectional Details
Principal Moments Iy:	0.000 in ⁴		PART NO
Section Modulus Ix:	0.000 in ³		2025-86-95 with 5350
Section Modulus Iy:	0.000 in ³		REV
			SHEET 1 OF 1

ITEM	PART #	DESCRIPTION
1	2025	Single Face Body
2	5322	Single Face Body Corner Angle
3		.060 Alum. Back
4		Alum. Back Support
5		Alum. Gusset
6		LED Module
7	2086	Tension Frame II
8	5210	Corner Key
9	5305	Frame Corner Angle
10	2095	Bleed Tension Frame Cover
11	2175	Frame Support Tube
12	5357	2 Piece Frame Brace

NOTE: PRE-CUT KITS ARE NOT PRE-DRILLED.
 (Holes shown in this drawing are for reference only.
 Drilling of pilot holes are to be done by fabricator.)

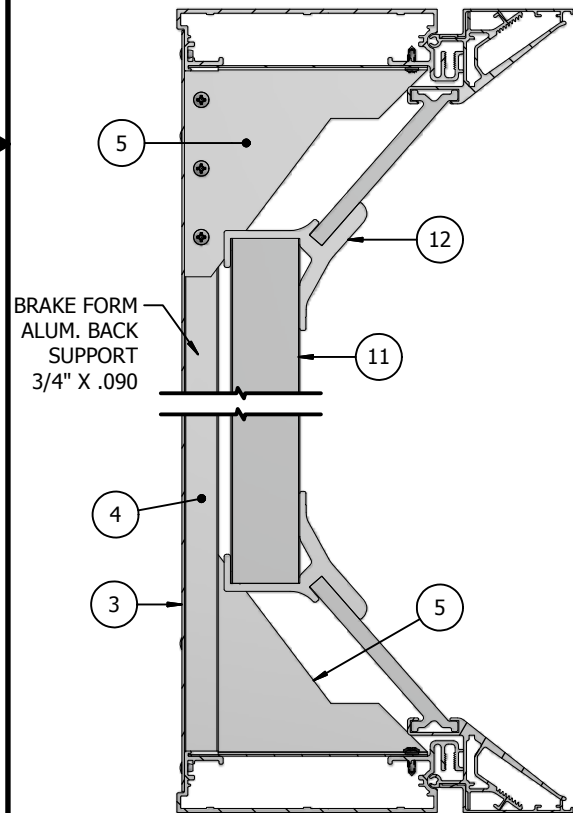

SECTION VIEW - STRUCTURAL

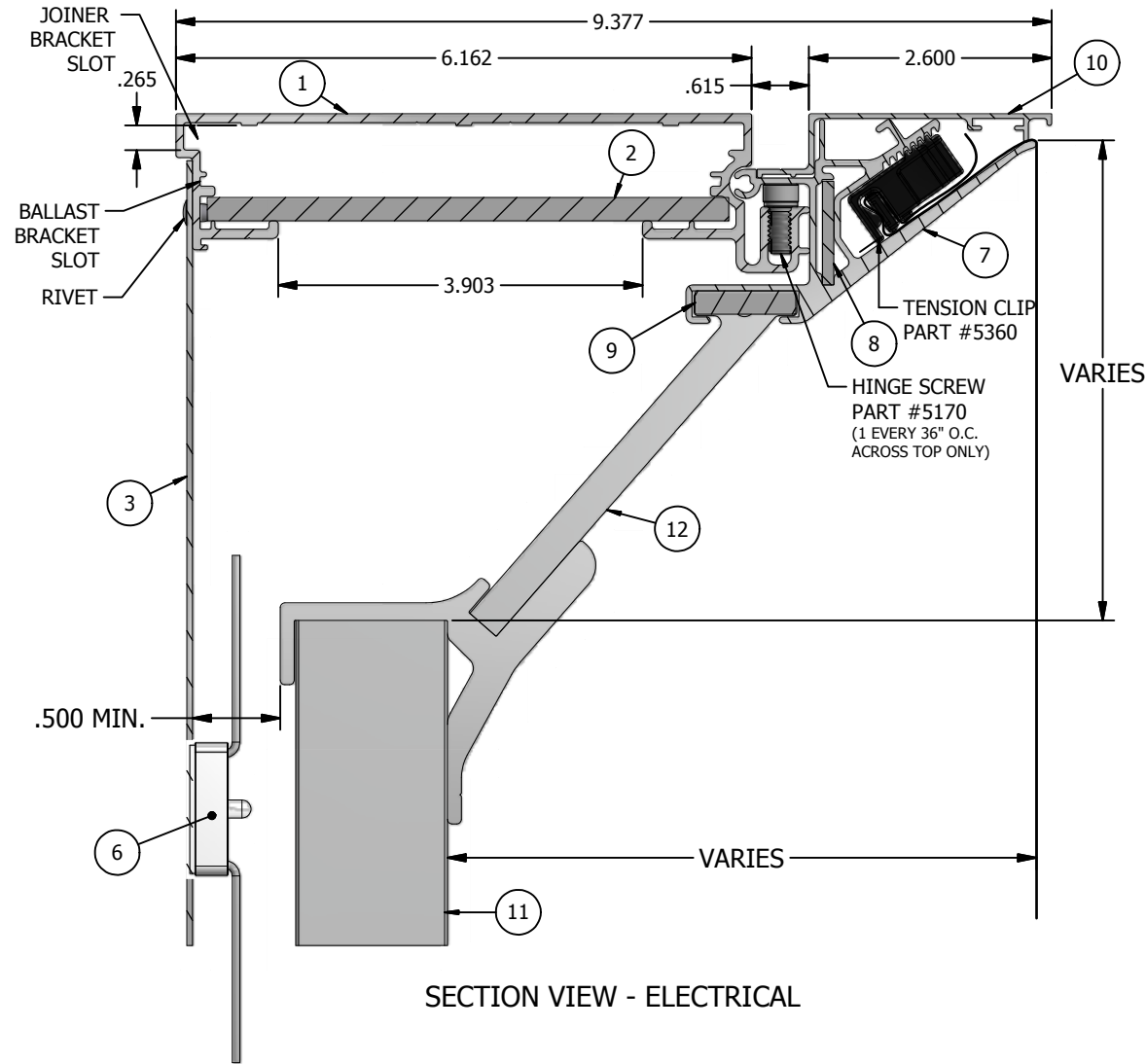

SECTION VIEW - ELECTRICAL

NOTES

1. THE FRAME SUPPORT TUBE SHOULD BE AT A MINIMUM OF 1/2" OFF OF THE BACK, BUT NOT TO EXCEED 3/4".
2. SIGNCOMP DOES NOT SUPPLY THE POWER SUPPLY, LED'S OR MOUNTING PROVISIONS.
3. SIGNCOMP DOES NOT SUPPLY THE MATERIAL FOR GUSSETS, 1/4" JOINER BRACKETS OR ALUMINUM BACK.

NOTE:

All structural detailing for sign construction is the sole responsibility of the sign contractor. All details shown here should be considered as **DESIGN INTENT ONLY**. The sign fabricator shall provide engineering drawings stamped by a licenced structural engineer.

THIS DRAWING WAS CREATED AT NO CHARGE TO ASSIST YOU IN VISUALIZING OUR PROPOSAL. THE DRAWING HEREIN IS THE PROPERTY OF SIGNCOMP. PERMISSION TO COPY OR REVISE THIS DRAWING OR TO USE THIS DRAWING FOR PRODUCTION IS STRICTLY PROHIBITED AND CAN ONLY BE COPIED, REVISED OR USED FOR PRODUCTION WITH THE EXPRESSED WRITTEN PERMISSION OF SIGNCOMP.

Project Name:	WB w/ Tension Frame II & Cover - Cross Sect.
Sign Company:	SignComp
Revision:	
Date:	10/7/2014
Sheet:	1 of 1
Size:	A
Drawing By:	SBreihof

SignComp